

"It takes an entire village to educate a child, just as it takes a child to educate a village".

Inspired by the profound connection between community and childhood, the primary school's design reflects the belief that education is not just limited to the walls of a classroom, but is enriched by cultural context and social interactions. The project is motivated by the necessity of the exchange between different times: it is impossible to look to the future without embracing the past or to design a child-friendly space without considering the surrounding community.

The school is conceived as an educational village, reflecting the strong connection of the local community with its cultural roots and traditions. The circle was chosen as the base shape for the project, as it is an organic and symbolically powerful shape. The entire school program is arranged around a Baobab tree whose shadow represents a public space par excellence. This central courtyard becomes the pulsating heart of the project, providing outdoor space for play, group activities, and learning, as well as serving as a space where the community comes together to share knowledge and experiences.

The functional program is organized circularly around this center, like a nest embracing the existing tree. Classrooms, school refectory, and kitchen, laboratory area, office and administrative spaces, restrooms, storage, and infirmary are distributed in enclosed or semi-enclosed blocks, while a series of qualified multi-purpose spaces such as corridors and courtyards are arranged between these volumes.

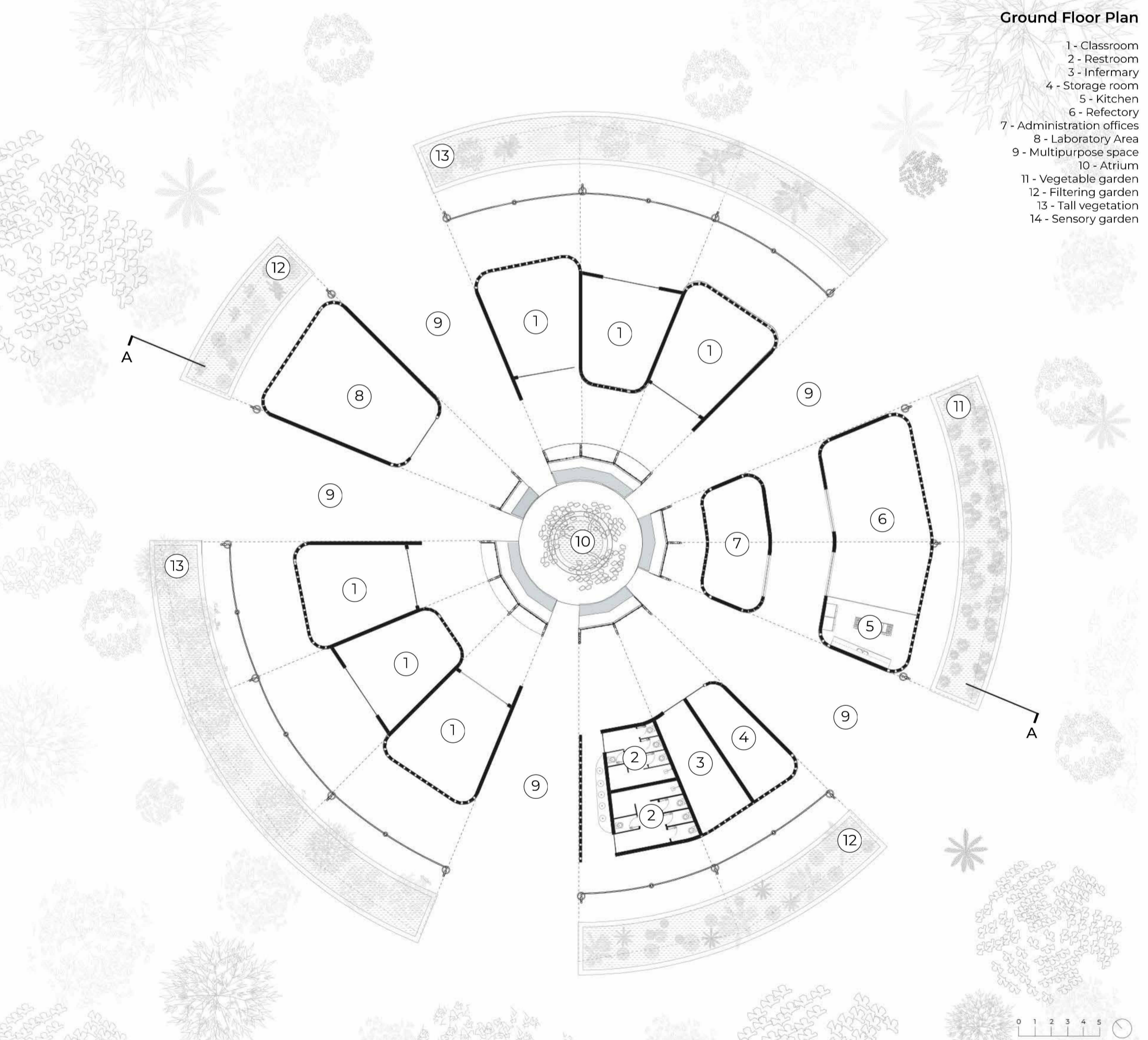

The school's design assembles to the Senegalese traditional construction, incorporating local traditional materials and techniques. Conceptually, opposite concepts were used, combining the rigidity and stability of the adobe block walls with the lightness and flexibility of the bamboo roof. The use of Adobe bricks is justified not only due to their local availability but also their low cost and sustainability. The production of these bricks involves the community and promotes the revival of traditional construction techniques. Besides allowing cross ventilation, the roof also plays a practical role in capturing rainwater. Bamboo brise-soleils surround the classrooms, protecting them from dust and strong winds while shading the surrounding circulation spaces, creating a series of gathering areas.

As for the furniture, the module is built with local wood and adaptable to different heights, which allows it to be used by different classes and combinations.

